

## CONFIGURATION OPTIONS

### KEYPAD / DECODER PANEL WITH WIRELESS RECEIVER

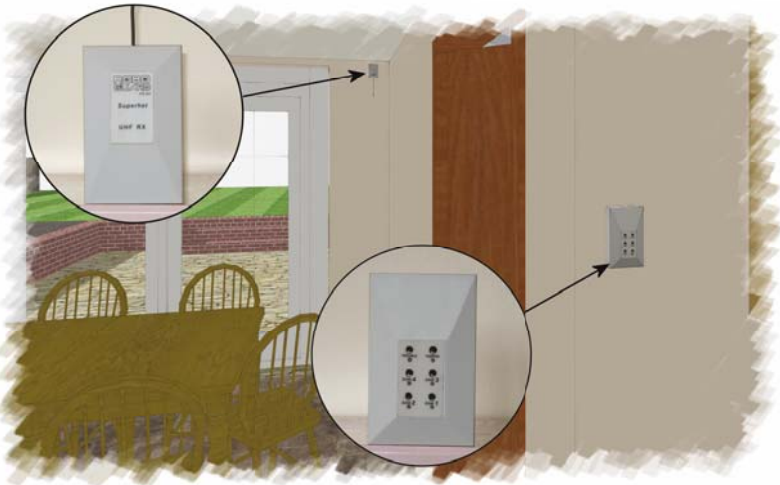

The keypad / decoder panel with separate wireless receiver (uRx) is perfect for buildings where wireless reception inside the building is limited, for example for those buildings where you get limited mobile phone coverage inside.

The keypad can accept four inputs and has four output channels. You can attach multiple keypads to one wireless receiver, allowing you to scale up and install larger sensor configurations.

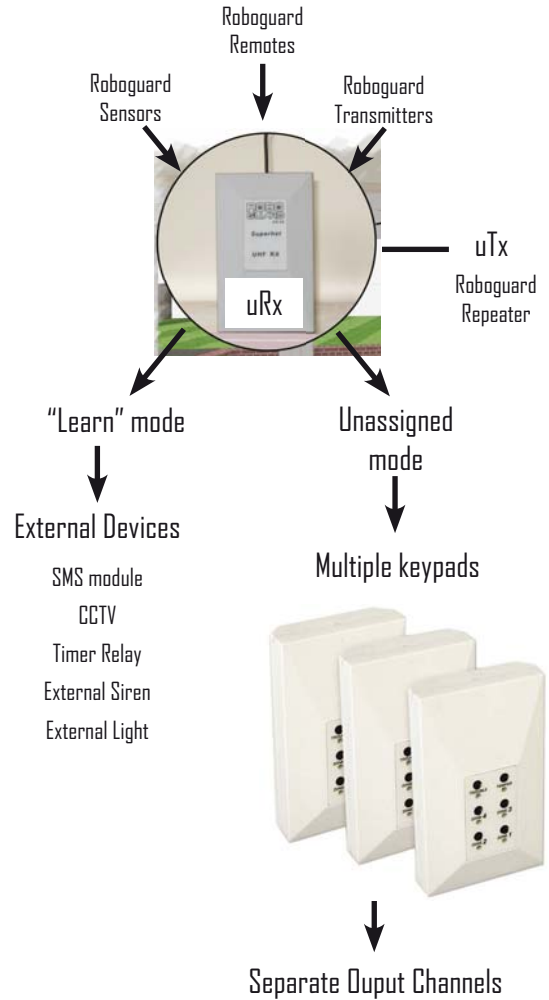

## TECHNICAL FEATURES

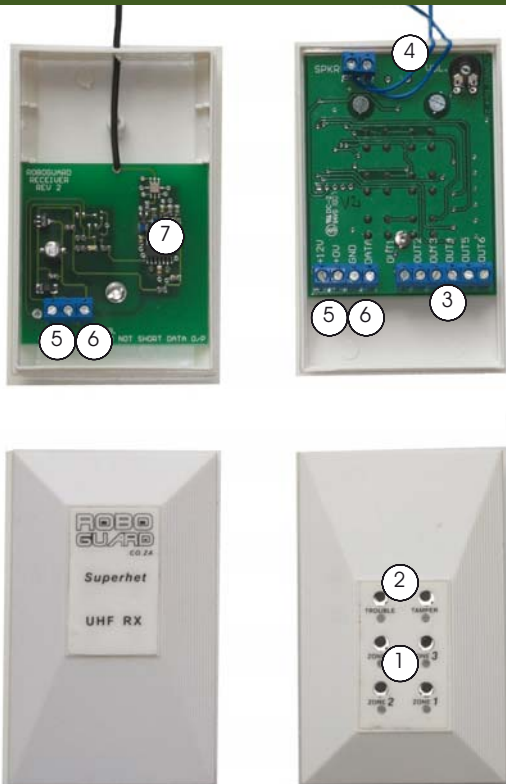

- ① Four Individual Intruder Zones with LED's visual alerts. Each Zone also generates a coded audible bleep depending on zone triggered.
- ② Separate tamper and trouble LED's makes for easy diagnostics.
- ③ Six output ports with multiple programming combinations make for easy implementation for various applications.
- ④ Separate speaker output channel with volume control.
- ⑤ Keypad and Wireless Receiver is powered by 12 volts DC for easy installation with existing alarm panels.
- ⑥ The uRx has a single data output channel which can be hard-wired to multiple devices. In unassigned mode, the data output channel is sent to a keypad where the assignment process links a alarm sensor to a particular zone on the keypad. In "learn" mode, the uRx learns the particular sensor code and only sends a pulsed signal once that sensor is triggered. If a latched uRx is used then the sensor input signal will switch output from NO to NC or vice versa.
- ⑦ The uRx can be "taught" to respond to any particular roboguard radio signal – Tamper, Intruder, Auto-test and Remote Tx.